

- DRAWING KEY**
- Existing street tree
  - Existing Liquid Amber tree
  - Existing Jacaranda tree
  - Existing Peppercorn tree
  - Proposed Chinese Elm tree
  - Tree to be removed
  - Temporary pedestrian barrier (to be removed when plants mature)
  - Proposed hedge (max 600mm high) (to match MMC standard planting)
  - Existing hedge
  - Existing surface swale
  - Paving Type 1 - New paving areas
  - Paving Type 2 - Replace concrete with paving, subject to future funding
  - Paving Type 3 - Revitalise existing paving, subject to future funding
  - New concrete surface
  - New sandstone block seating wall
  - Retain existing bus stop
  - No stopping zone

**CARPARKING NOTE:**  
The proposed streetscape upgrade works require removal of 2 carparking spaces in total.

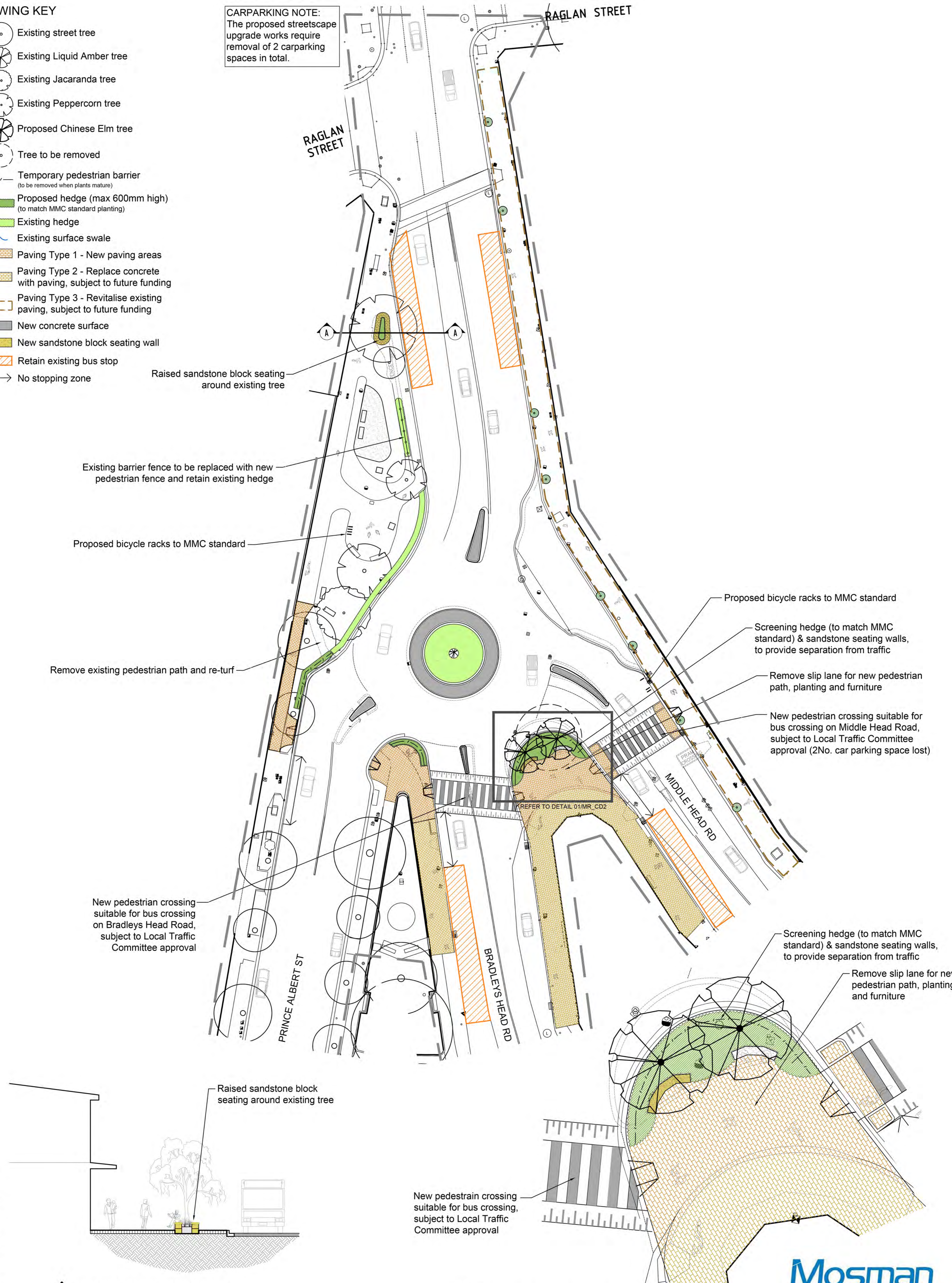

THOMPSON BERRILL LANDSCAPE DESIGN P/L

**AA** ELEVATION - MILITARY RD WEST  
SCALE 1:100

**01** DETAIL PLAN - MIDDLE HEAD RD & BRADLEYS HEAD RD  
SCALE 1:100



# CONCEPT DESIGN OPTION 2

# MILITARY RD STREETScape UPGRADE

**MR\_CD2**  
**AUG 2016**  
**SCALE 1: 250 @ A1**  
0 2.5 5 7.5 12.5 m